

HP+™ Wall System XR Series

Patent pending

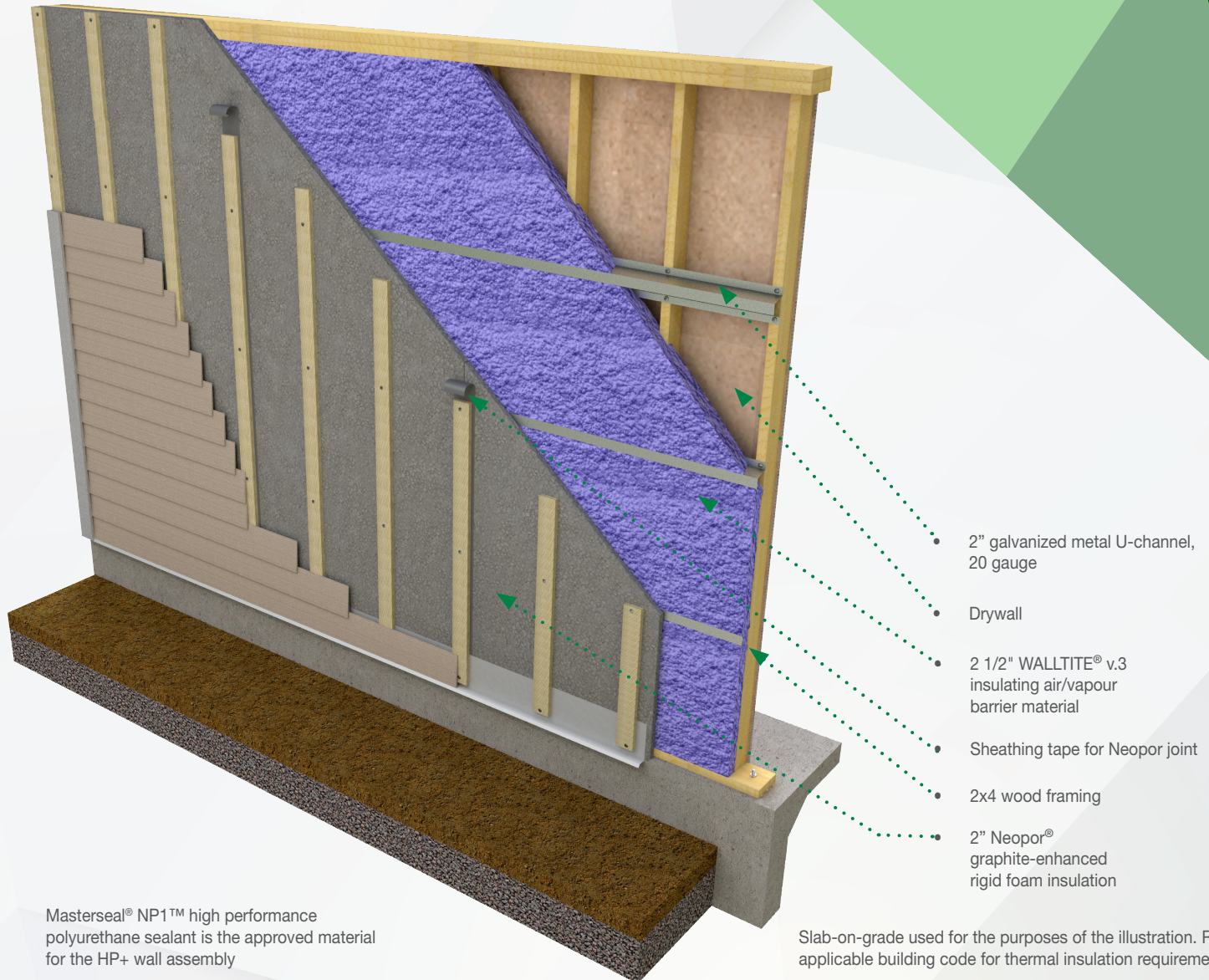

HP+ Wall System XR Series is a strong structural assembly that meets or exceeds building code requirements with a minimum nominal insulation R-value of R-25 up to R-45.8 with 2x4 wood framing. The XR series offers exceptional energy and cost efficiencies.

Build Stronger: Create a stronger wall assembly and use less wood than traditional construction

Build Smarter: Construct a wall assembly that incorporates continuous insulation and an air/vapour barrier system without the need for a conventional vapour or weather resistive barrier

Build Sustainable: Minimize energy loss with reduced air leakage and high R-values while enhancing indoor comfort.

BASF

We create chemistry

Systematic Success.

The HP+™ Wall System XR Series is designed to deliver a smart new way to build high performance homes affordably.

The wall assembly features the following:

- 2x6 bottom and top plates
- 2x4 wood framing at 16" or 24" on center construction
- 2" Neopor® graphite-enhanced rigid thermal foam insulation available in different thicknesses and R-values to fit your climate zone needs and code requirements
- MasterSeal® NP1™ sealant
- 2 1/2" WALLTITE® HP+ High Performance insulating air/vapour barrier material
- 20 gauge, 2" thick galvanized U-channel at 24" on centre
- Extra room to add more WALLTITE for an increased R value

The HP+ Wall System XR Series is just one of the offerings in our growing portfolio of HP+™ Wall Systems, which are paired with our HP+™ Consultative Solutions to complete our groundbreaking BEYOND.High Performance® approach to construction. With BEYOND.High Performance, BASF provides you with the expertise and solutions you need to meet new and changing codes and build affordable, sustainable high performance homes.

Visit us at www.walltite.com
or call 1-866-474-3538 to learn more.

Strength in Numbers

By combining 2x4 framing with foam sheathing and spray polyurethane foam in a composite design, the HP+ Wall System XR Series can increase structural strength while reducing lumber content and eliminating the need for plywood or OSB sheathing. When properly designed and installed, the HP+ Wall System can offer one of the best values available for residential construction. Benefits include:

- Can reduce lumber content by up to 25%
- Stronger walls, with a lateral load resistance up to 35% greater than a wall with typical framing and fully sheathed with OSB.
- Improved moisture management that can mitigate thermal and structural issues; reducing possible builder callbacks

Build a Better Barrier: Thermal, Air, Water and Vapour Drive

With integrated thermal, air, water and vapour flow management in a single system, the HP+Wall System XR Series provides an effective building envelope against severe Canadian climates

- Provides higher thermal performance in 2 x 4 wood framing, increasing the interior square footage
- Reduces thermal bridging through continuous insulation which also performs as a weather resistive barrier
- Creates a superior air and vapour barrier using WALLTITE and MasterSeal NP1

Tested wall assembly. Increased peace of mind

The HP+ Wall System XR Series has been tested by third party laboratories and reviewed by an independent engineering firm.

- The Technical Evaluation Report (TER) provides installation guidelines to build the HP+ Wall XR series assembly to meet the National Building Code's structural, wind and seismic load resistance requirements
- The energy performance of the HP+ Wall XR series total assembly has been tested as per ASTM Standards
- HP+ Wall XR series total assembly has been tested for air leakage as per CAN/ULC-S741 and CAN/ULC-S742

BEYOND.High Performance™ is a registered service mark of BASF.
WALLTITE® is a registered trademark of BASF Canada Inc.
Neopor® is a registered trademark of BASF SE, used with permission by BASF Canada.
MasterSeal® is a registered trademark of BASF SE, used with permission by BASF Canada.

© 2016 BASF Canada Inc.

NOTE: To perform as per the Technical Evaluation Report (TER) the HP+ Wall System XR series MUST follow the installation guidelines described in the TER.